



Easy Installation Guide - On-the-Ground Cap Removal Method

Thank you for purchasing this Cap-Pack® Innovative Truck Storage product. This Easy Installation Guide contains instructions for the Cap Removal Method. In this method, you remove the cap, install the Cap-Pack® Sport in the cap, and then reinstall the cap on the truck. Visit our website at <https://www.cap-pack.com/accessories.html> for information on additional accessories.

Overview:

- Remove the truck cap and place cap upside down on supports.
- Place, center position, and align the Cap-Pack® Sport in the cap.
- Slide open the Cap-Pack® Sport drawer to confirm the draw has proper clearance.
- Install and tighten the mounting hardware.
- Install the cap on the truck and confirm proper Cap-Pack® Sport installation.

Follow the instructions below. For further details, watch the installation video on the product pages at <https://www.cap-pack.com>

Models CPS-5 and CPS-6

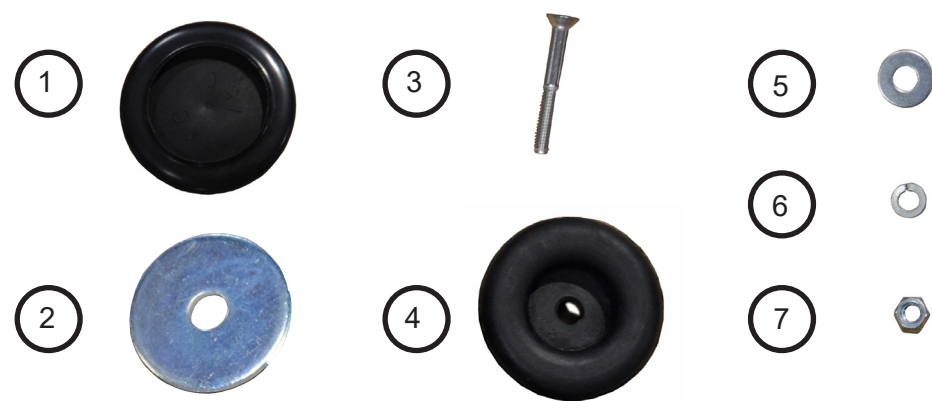

Parts List

Item No.	Part Description	Quantity
1	Nylon Weather Seal Cover	4
2	Reinforcement Washer	4
3	5/16 inch stainless steel bolt	4
4	Rubber bumper	4
5	5/16 inch flat washer	4
6	5/16 inch split lock washer	4
7	5/16 inch nut	4

STEP 1

Foam stacker (two locations)



CAUTION: Use appropriate manpower to remove and install the cap. Refer to the cap manufacturer's instructions and safety guidelines.



CAUTION: The Cap-Pack® Sport is rated for 100 lb. capacity (evenly distributed weight).

Remove the clamps and your cap, per the cap manufacturer's instructions. Turn the cap upside down and place it on a level surface. Use the shipping carton as a placement surface. If the cap does not have a roof rack, use the 4x6 inch shipping foam stackers as support and spacers for the cap.

STEP 2

Position Cap-Pack® Sport for correct alignment and adequate clearance.



Set the Cap-Pack® Sport in the cap, centering and aligning it so that the drawer will open freely. Use measuring tools and observation, to make sure the Cap-Pack® Sport is centered and parallel to the cap. Make sure the drawer opens parallel to the cap. Important: Determine the set back from cap opening by opening the drawer and lifting it out past the back of the cap opening. The Cap-Pack® Sport drawer should freely open and close, with adequate clearance.

STEP 3

Use a marker and mark the location of the four cap roof holes you are going to drill. The mounting openings on the Cap-Pack® Sport frame are slotted to allow for width adjustments to accommodate other ceiling mounted accessories (ladder rack, etc.). For your reference, also mark on the frame where it aligns with the drill holes you marked.



Marking drill hole (4 locations)



STEP ④



Slide the Cap-Pack® Sport frame out of the way. Drill each of the four holes in the cap ceiling at the marked locations with a 3/8 inch bit. Reposition the frame after drilling the holes, aligning the holes with the frame reference marks you made in step 3.

STEP ⑤

Nylon Weather Seal Cover (Item No.1) and Reinforcement Washer (Item No. 2).

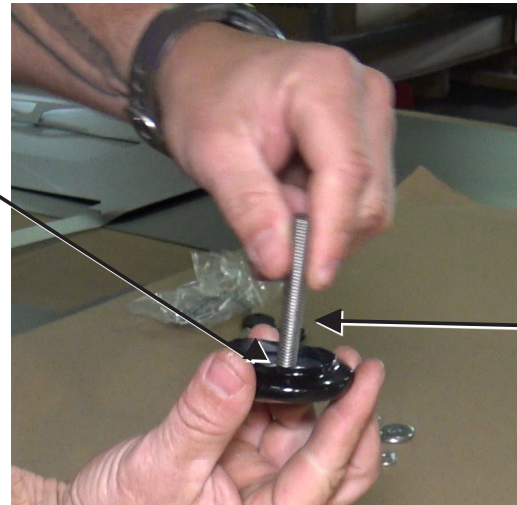

Insert 5/16 inch stainless steel bolt (Item No. 3) into a reinforcement washer (Item No. 2). Stretch the nylon weather seal cover (Item No. 1) over the washer and bolt head. Repeat for all four bolts.

5/16 inch stainless steel Bolt (Item No. 3)

STEP ⑥

Rubber Bumper (Item No. 4) (4 locations)



Insert the bolt (Item No. 3) into the cap from the outside. Lift the frame up and mount the rubber bumper (Item No. 4) on the bolt. Position the rubber bumper between the cap ceiling and the frame, with the flat side of the rubber bumper flush to the cap ceiling.

Install the remaining frame fastening hardware on the bolt:

- 5/16 inch flat washer (Item No. 5).
- 5/16 inch split lock washer (Item No. 6)
- 5/16 inch nut (Item No. 7)

Hand tighten the hardware to the frame. Repeat for all four corners. Then tighten so that the rubber bumper compresses approximately 1/4 inch.

STEP ⑦

Frame stop (safety) bolt (2 locations)



Slide and close the Cap-Pack® Sport Drawer on the frame. Tighten the stop (safety) bolts on each side of the Cap-Pack® Sport using a 3/4 inch wrench.

STEP ⑧



Turn the cap over and inspect the nylon sealing covers. Reinstall the cap per the cap manufacturer's instructions and safety guidelines. Check the Cap-Pack® Sport for proper opening and closing. Congratulations, you have installed your Cap-Pack® Sport!

Check the frame mounting hardware for tightness after 500 miles. Periodically check.



CAUTION: For better weight distribution, keep the tailgate in the up position when lowering the Cap-Pack® Sport.